

RUNWAY 18 THRESHOLD
 LAT. 43° 23' 21.2649"
 LONG. 72° 11' 12.7943"
 ELEV. 780.97' MSL

RUNWAY 30 END
 LAT. 43° 23' 20.29210"
 LONG. 72° 11' 15.16243"
 ELEV. 777.00' MSL

AIRPORT REFERENCE POINT
 LAT. 43° 23' 14.08933"
 LONG. 72° 11' 15.52834"

RUNWAY 12-30 1,950' X 80' (TURF) (N 74° 45' 11.89" W)

RUNWAY 18-36 3,448' X 50' (S 13° 10' 30" W)

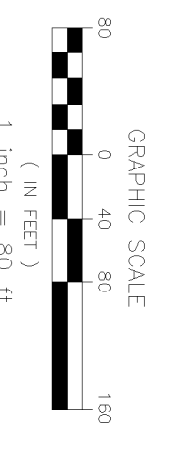
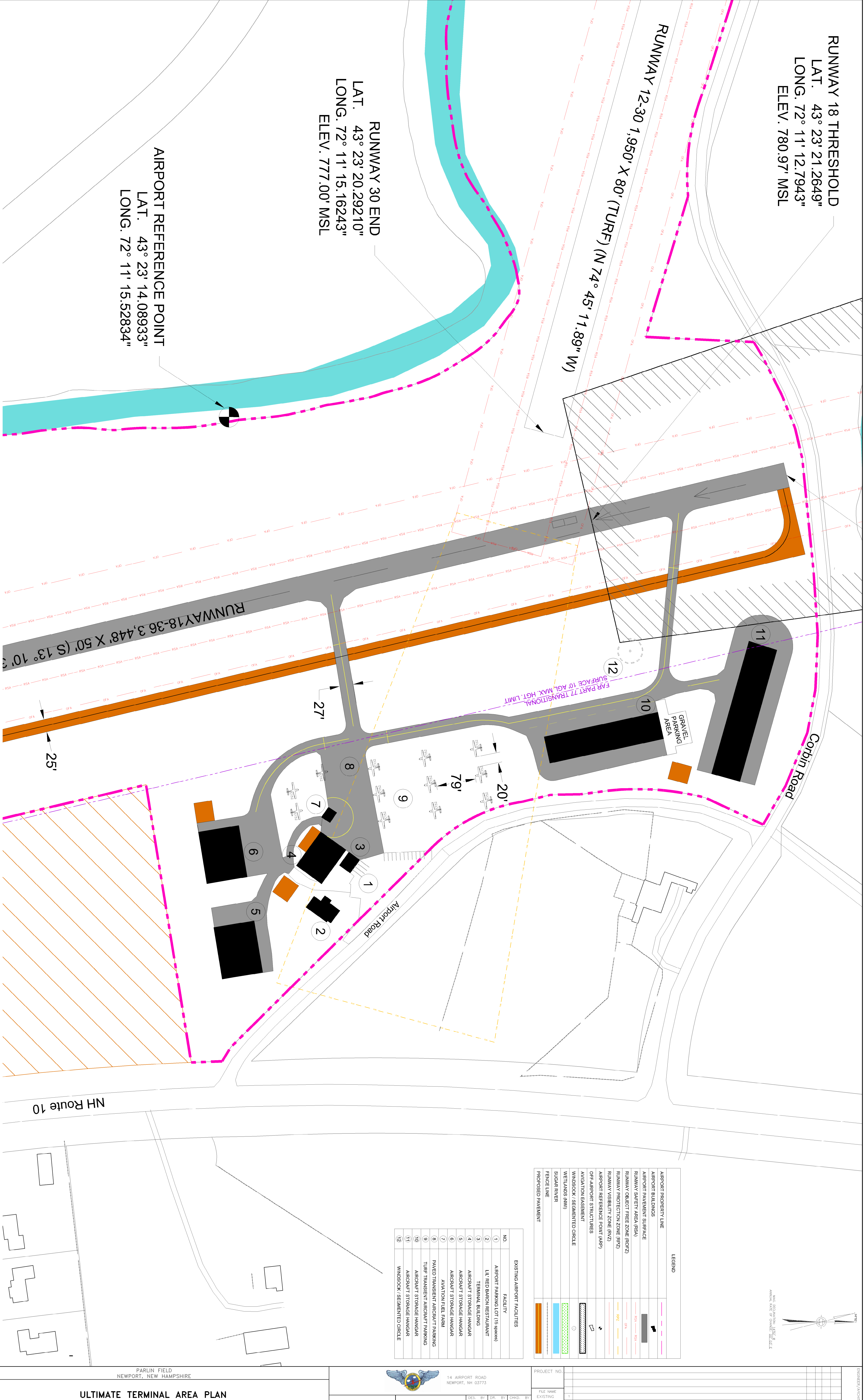

LEGEND

| | |
|----------|--------------------------------|
| [Symbol] | AIRPORT PROPERTY LINE |
| [Symbol] | AIRPORT BUILDINGS |
| [Symbol] | AIRPORT PAVEMENT SURFACE |
| [Symbol] | RUNWAY PAVEMENT SURFACE |
| [Symbol] | RUNWAY SAFETY AREA (RSA) |
| [Symbol] | RUNWAY OBJECT FREE ZONE (ROFZ) |
| [Symbol] | RUNWAY PROTECTION ZONE (RPZ) |
| [Symbol] | RUNWAY VISIBILITY ZONE (RVZ) |
| [Symbol] | AIRPORT REFERENCE POINT (ARP) |
| [Symbol] | OFF-AIRPORT STRUCTURES |
| [Symbol] | AVIATION EASEMENT |
| [Symbol] | WINDSOCK / SEGMENTED CIRCLE |
| [Symbol] | WETLANDS (NMW) |
| [Symbol] | SUGAR RIVER |
| [Symbol] | TRACE LINE |
| [Symbol] | PROPOSED PAVEMENT |

EXISTING AIRPORT FACILITIES

| NO. | FACILITY |
|-----|----------------------------------|
| 1 | AIRPORT PARKING LOT (15 spaces) |
| 2 | LIT. RED BARON RESTAURANT |
| 3 | TERMINAL BUILDING |
| 4 | AIRCRAFT STORAGE HANGAR |
| 5 | AIRCRAFT STORAGE HANGAR |
| 6 | AIRCRAFT STORAGE HANGAR |
| 7 | AVIATION FUEL FARM |
| 8 | PAVED TRANSIENT AIRCRAFT PARKING |
| 9 | TURF TRANSIENT AIRCRAFT PARKING |
| 10 | AIRCRAFT STORAGE HANGAR |
| 11 | AIRCRAFT STORAGE HANGAR |
| 12 | WINDSOCK / SEGMENTED CIRCLE |

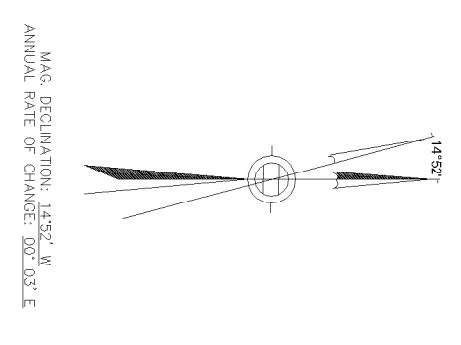

NH Route 10

Corbin Road

Airport Road